

conische tandwielen  
*pignons coniques*  
 staal / acier: EN8 (C45)  
**1 : 3**

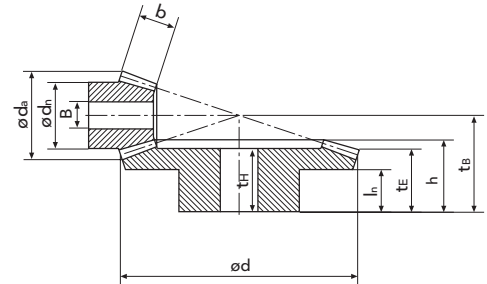

03

module	Z*	da	d	b	ln	dn	B	tB	h	tH	tE	Kg	code
<b>1,0</b>	15	16,90	15,0	7,0	8,0	12,5	5,0	31,0	15,4	14,5	8,82	0,012	<b>151-510-015</b>
	45	45,63	45,0	7,0	10,0	28,0	10,0	22,0	17,4	15,5	15,45	0,102	<b>151-510-045</b>
<b>1,5</b>	15	25,35	22,5	10,0	11,6	19,0	8,0	46,0	22,1	21,0	12,72	0,039	<b>151-515-015</b>
	45	68,45	67,5	10,0	14,5	40,0	14,0	31,0	23,9	21,5	21,17	0,300	<b>151-515-045</b>
<b>2,0</b>	15	33,79	30,0	14,0	14,0	25,0	12,0	60,0	28,7	27,0	15,63	0,082	<b>151-520-015</b>
	45	91,26	90,0	14,0	20,0	50,0	18,0	41,0	31,7	28,0	27,89	0,632	<b>151-520-045</b>
<b>2,5</b>	15	42,24	37,5	17,5	15,5	31,0	14,0	73,0	33,8	32,0	17,54	0,155	<b>151-525-015</b>
	45	114,08	112,5	17,5	22,0	60,0	20,0	48,0	36,4	32,0	31,62	0,150	<b>151-525-045</b>
<b>3,0</b>	15	50,68	45,0	21,0	17,5	38,0	16,0	86,0	39,0	37,0	19,45	0,275	<b>151-530-015</b>
	45	136,89	135,0	21,0	25,0	70,0	22,0	56,0	42,1	37,0	36,34	1,900	<b>151-530-045</b>
<b>3,5</b>	15	59,13	52,5	24,5	20,0	44,0	18,0	100,0	45,2	43,0	22,35	0,440	<b>151-535-015</b>
	45	159,71	157,5	24,5	28,0	80,0	25,0	64,0	47,8	42,0	41,07	9,950	<b>151-535-045</b>
<b>4,0</b>	15	67,58	60,0	28,0	22,5	50,0	20,0	114,0	51,4	49,0	25,26	0,650	<b>151-545-015</b>
	45	182,52	180,0	28,0	32,0	90,0	30,0	73,0	54,5	48,0	46,79	4,320	<b>151-545-045</b>
<b>4,5</b>	15	76,03	67,5	31,0	24,5	55,0	22,0	128,0	57,1	54,0	28,17	0,910	<b>151-545-015</b>
	45	205,34	202,5	31,0	35,0	105,0	35,0	81,0	60,1	53,0	51,52	6,180	<b>151-545-045</b>
<b>5,0</b>	15	84,48	75,0	34,0	27,0	60,0	25,0	142,0	62,8	60,0	31,08	1,210	<b>151-550-015</b>
	45	228,16	225,0	34,0	38,0	120,0	40,0	89,0	65,6	58,0	56,24	8,660	<b>151-550-045</b>
<b>6,0</b>	15	101,40	90,0	41,0	27,5	75,0	25,0	165,0	70,2	66,0	31,89	2,420	<b>151-560-015</b>
	45	273,78	270,0	41,0	35,0	140,0	45,0	98,0	70,0	60,0	58,69	17,510	<b>151-560-045</b>

onder hoek van / angle des axes: 90°

drukhoek / angle d'attaque: 20°

Z\*: aantal tanden / nombre de dents