

tandwielen, rechte vertanding

pignons droits

module **1.0** (b = 8 mm)

01

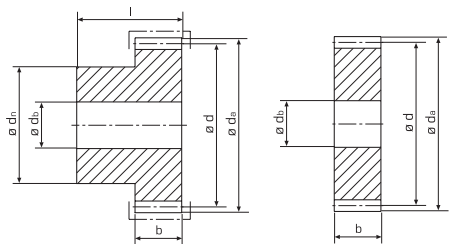

| Z* | b | l | da | d | dn | db | Kg | staal acier C45 (1.0503) | inductief gehard trepé inductif C45 (1.0503) | roestvrij inoxydable 1.4305 (X8 CrNiS 18-9) |
|-----|---|----|-------|-------|----|----|-------|-----------------------------------|---|--|
| 12 | 8 | 18 | 14,0 | 12,0 | 9 | 4 | 0,012 | 111-010-012 | - | - |
| 13 | 8 | 18 | 15,0 | 13,0 | 10 | 4 | 0,013 | 111-010-013 | - | - |
| 14 | 8 | 18 | 16,0 | 14,0 | 11 | 4 | 0,115 | 111-010-014 | - | - |
| 15 | 8 | 18 | 17,0 | 15,0 | 12 | 5 | 0,016 | 111-010-015 | 111-010-415 | 111-010-615 |
| 16 | 8 | 18 | 18,0 | 16,0 | 12 | 5 | 0,017 | 111-010-016 | - | - |
| 17 | 8 | 18 | 19,0 | 17,0 | 14 | 6 | 0,022 | 111-010-017 | - | - |
| 18 | 8 | 18 | 20,0 | 18,0 | 15 | 6 | 0,024 | 111-010-018 | - | - |
| 19 | 8 | 18 | 21,0 | 19,0 | 15 | 6 | 0,026 | 111-010-019 | - | - |
| 20 | 8 | 18 | 22,0 | 20,0 | 15 | 6 | 0,027 | 111-010-020 | 111-010-420 | 111-010-620 |
| 21 | 8 | 18 | 23,0 | 21,0 | 18 | 6 | 0,036 | 111-010-021 | - | - |
| 22 | 8 | 18 | 24,0 | 22,0 | 18 | 6 | 0,038 | 111-010-022 | - | - |
| 23 | 8 | 18 | 25,0 | 23,0 | 18 | 6 | 0,042 | 111-010-023 | - | - |
| 24 | 8 | 18 | 26,0 | 24,0 | 18 | 6 | 0,044 | 111-010-024 | - | - |
| 25 | 8 | 18 | 27,0 | 25,0 | 18 | 6 | 0,045 | 111-010-025 | 111-010-425 | 111-010-625 |
| 28 | 8 | 18 | 30,0 | 28,0 | 20 | 8 | 0,054 | 111-010-028 | - | - |
| 30 | 8 | 18 | 32,0 | 30,0 | 20 | 8 | 0,059 | 111-010-030 | 111-010-430 | 111-010-630 |
| 36 | 8 | 18 | 38,0 | 36,0 | 25 | 8 | 0,094 | 111-010-036 | - | - |
| 38 | 8 | 18 | 40,0 | 38,0 | 25 | 8 | 0,098 | 111-010-038 | - | - |
| 40 | 8 | 18 | 42,0 | 40,0 | 25 | 8 | 0,108 | 111-010-040 | 111-010-440 | 111-010-640 |
| 45 | 8 | 18 | 47,0 | 45,0 | 30 | 8 | 0,145 | 111-010-045 | - | - |
| 48 | 8 | 18 | 50,0 | 48,0 | 30 | 8 | 0,160 | 111-010-048 | - | - |
| 50 | 8 | 18 | 52,0 | 50,0 | 35 | 8 | 0,185 | 111-010-050 | - | - |
| 52 | 8 | 18 | 54,0 | 52,0 | 35 | 10 | 0,190 | 111-010-052 | - | - |
| 56 | 8 | 18 | 58,0 | 56,0 | 35 | 10 | 0,210 | 111-010-056 | - | - |
| 60 | 8 | 18 | 62,0 | 60,0 | 40 | 10 | 0,260 | 111-010-060 | 111-010-460 | 111-010-660 |
| 76 | 8 | - | 78,0 | 76,0 | - | 10 | 0,274 | 110-010-076 | - | - |
| 80 | 8 | - | 82,0 | 80,0 | - | 10 | 0,298 | 110-010-080 | - | - |
| 95 | 8 | - | 97,0 | 95,0 | - | 10 | 0,430 | 110-010-095 | - | - |
| 120 | 8 | - | 122,0 | 120,0 | - | 10 | 0,675 | 110-010-120 | - | - |

ingrijphoek / angle d'attaque: 20°

Z*: aantal tanden / nombre de dents

© Aandrijvingen Gallon NV 100510